

PROPRIETAIRE: CANOREGIE SA
 ADRESSE DE LOUVRAGE:
 PARCELLE N°17
 1417 ESSERLINES-SUR-VERPION
 RUE DE LA LAITERIE 1

SITUATION
 CONSTRUCTION
 D'UN IMMEUBLE
 DE 6 LOGEMENTS
 DATE: 2021 - 01 - 18 | ECHELLE: 1-200 (A3)

Atelier devaud
 architecture
 Rue de la Chanaille 1 • CH-1037 Ecaussinnes
 T. 021/732 24 64 • F. 021/732 24 65 • M. 079/467 29 61
<http://atelierdevaud.ch>

- LOT 1
- LOT 2
- LOT 3
- LOT 4
- LOT 5
- LOT 6

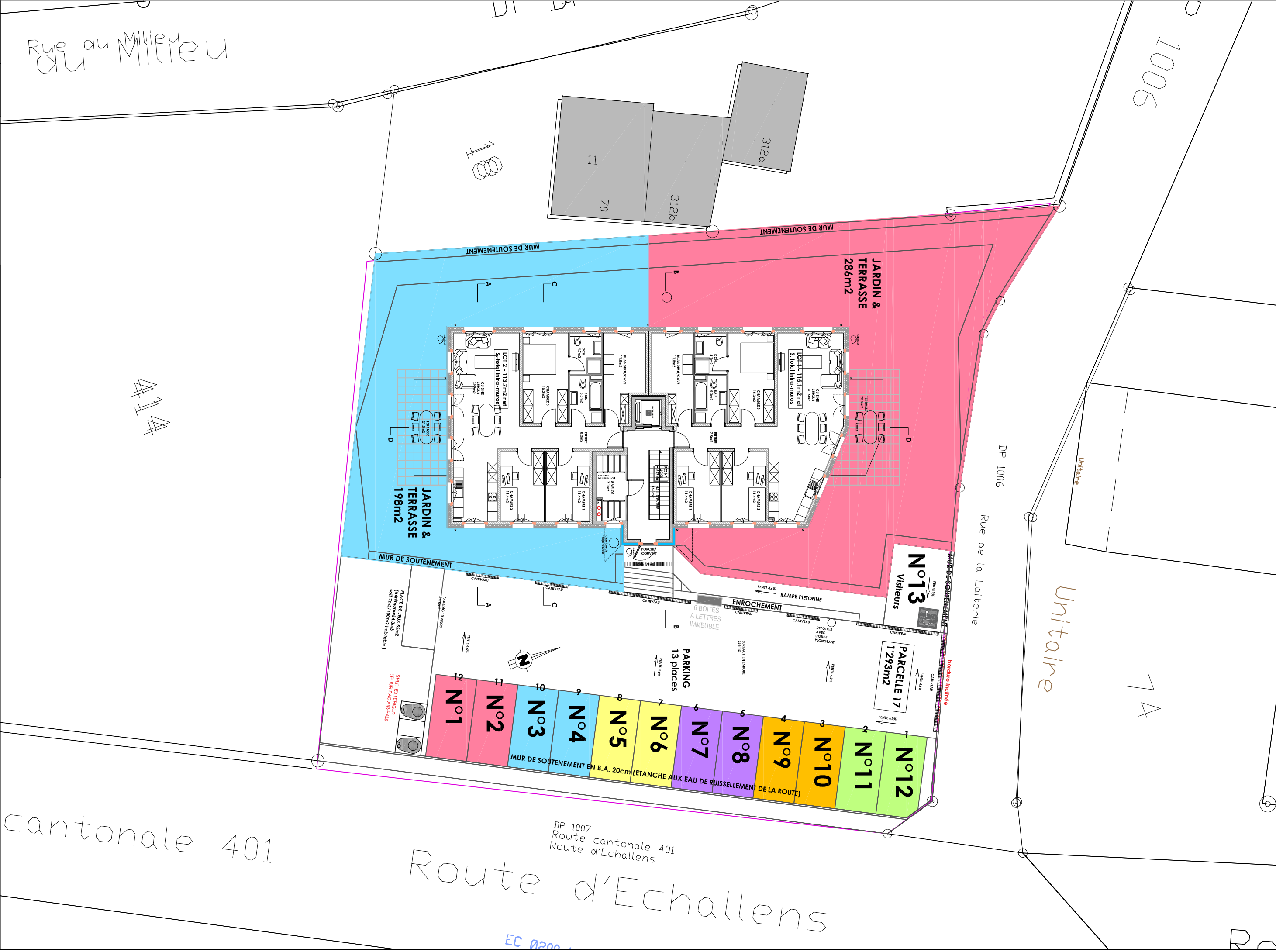

cantonale 401

Route d'Echallens

DP 1007
 Route cantonale 401
 Route d'Echallens

Unitaire

Rue de la Laiterie

1006

74

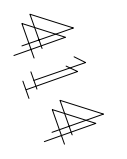
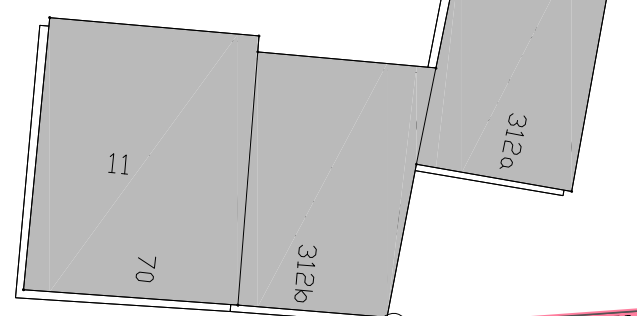

EC 0200